

AE-NVA MOTORIZED NEEDLE FLOW CONTROL VALVE

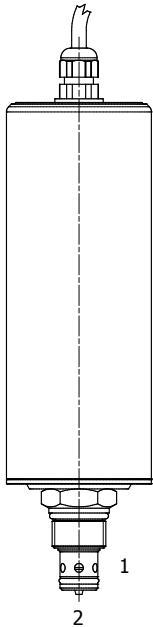

DESCRIPTION

10 size, 7/8-14 thread, "Delta" series, motorized needle flow control valve.

OPERATION

The AE-NVA can be adjusted to any position between fully open and fully closed applying electrical power to the motor. The amount of valve opening does not change unless the electric motor is activated. When adjusted open, the valve allows flow from (1) to (2) and (2) to (1). When fully closed the valve blocks flow from (1) to (2) and (2) to (1).

FEATURES

- Hardened parts for long life.
- Industry common cavity.



Product when adjusted fully closed does not close to zero flow. (.5 to 1 GPM @ 200 PSI)

HYDRAULIC SYMBOL

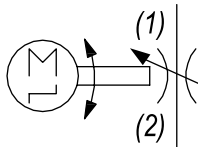

PERFORMANCE

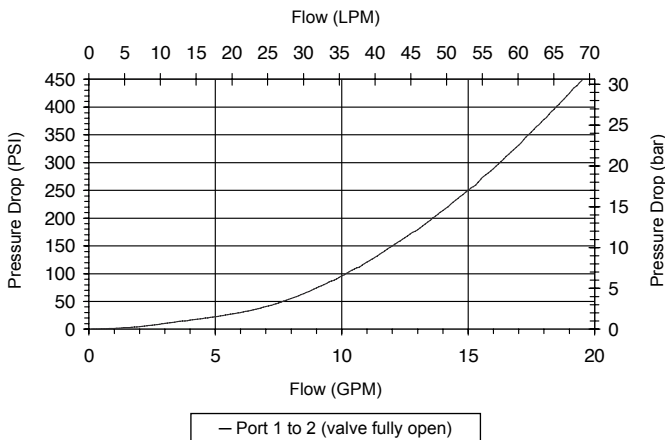

VALVE SPECIFICATIONS

| | |
|-------------------------------|---------------------------------|
| Nominal Flow | 10 GPM (38 LPM) |
| Rated Operating Pressure | 3500 PSI (241 bar) |
| Viscosity Range | 36 to 3000 SSU (3 to 647 cSt) |
| Filtration | ISO 18/16/13 |
| Media Operating Temp. Range | -40° to 250°F (-40° to 120°C) |
| Weight | 1.68 lbs (.76 kg) |
| Operating Fluid Media | General Purpose Hydraulic Fluid |
| Cartridge Torque Requirements | 30 ft-lbs (40.6 Nm) |
| Travel Time at Rated Voltage | 10-12 sec Min. to Max. Setting |
| Power Requirements | 5 Watts |
| Allowable Input Voltage | 80% - 120% of Rated |
| Cavity | DELTA 2W |
| Cavity Form Tool (Finishing) | 40500000 |
| Seal Kit | 21191200 |

| Gear ratio | Response time (full closed to full open) |
|------------|--|
| 100 | 12 sec. |
| 250 | 28 sec. |
| 500 | 55 sec. |

WARNING: the specifications/application data shown in our catalogs and data sheets are intended only as a general guide for the product described (herein). Any specific application should not be undertaken without independent study, evaluation, and testing for suitability.



4484 Boeing Drive Rockford, IL 61109 • USA • Phone +1 (815) 397-6628 • Fax +1 (815) 397-2526
 mail: delta@delta-power.com • www.delta-power.com



Via Malavolti, 36 • 41122 Modena • ITALY • Phone +39 (059) 254895 • Fax +39 (059) 253512
 mail: tecnord@tecnord.com • www.tecnord.com

DIMENSIONS

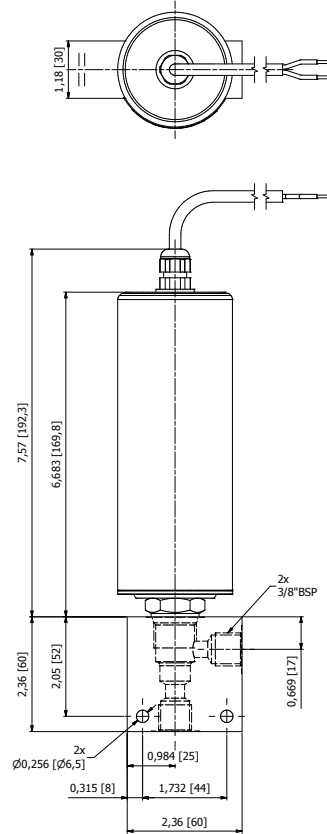
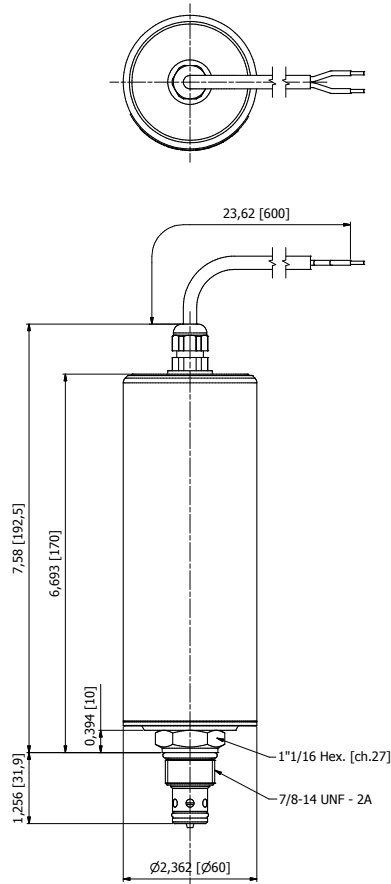

(for bodies style and sizes see section "Accessories")

ORDERING INFORMATION

| | | | | | |
|-----------------|--|-------------------|---|----------------|----------------|
| AE-NVA - | | - | - | - | - |
| | | OPTIONS | | BODIES | |
| Buna Standard | | 00 | | Blank | Without Body |
| | | | | N | 3/8" NPT Ports |
| | | | | S | #8 SAE Ports |
| | | GEAR RATIO | | VOLTAGE | |
| | | R500 | | 24 | 24 VDC |
| | | R250 | | 12 | 12 VDC |
| | | R100 | | | |

Note: Dual lead termination (60 cm long.)

W 2 / 2020

WARNING: the specifications/application data shown in our catalogs and data sheets are intended only as a general guide for the product described (herein). Any specific application should not be undertaken without independent study, evaluation, and testing for suitability.



4484 Boeing Drive Rockford, IL 61109 • USA • Phone +1 (815) 397-6628 • Fax +1 (815) 397-2526
 mail: delta@delta-power.com • www.delta-power.com



Via Malavolti, 36 • 41122 Modena • ITALY • Phone +39 (059) 254895 • Fax +39 (059) 253512
 mail: tecnord@tecnord.com • www.tecnord.com